

# Why Did the Elephant Paint His Toenails Red, Green, Yellow, Blue, and Purple?

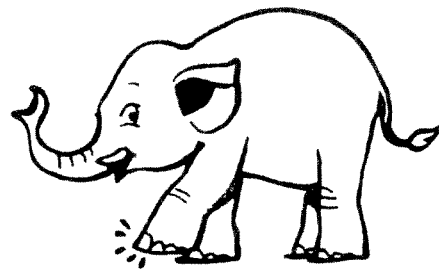

Find each answer in the appropriate set of boxes at the bottom of the page.  
Write the letter of the exercise in the box containing the answer.

I. Find the length of one side (s) of each square.

Ⓒ

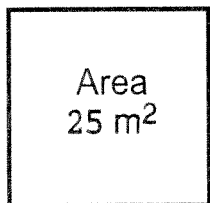

s = \_\_\_\_\_ m

Ⓘ

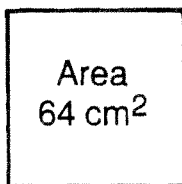

s = \_\_\_\_\_ cm

Ⓔ

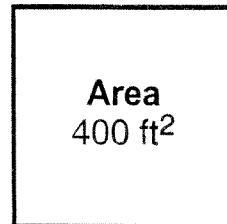

s = \_\_\_\_\_ ft

II. Find the square root.

Ⓔ

$\sqrt{49}$

Ⓖ

$\sqrt{16}$

Ⓘ

$\sqrt{100}$

Ⓒ

$\sqrt{81}$

Ⓔ

$\sqrt{36}$

Ⓖ

$\sqrt{4}$

Ⓕ

$\sqrt{144}$

Ⓖ

$\sqrt{1}$

Ⓒ

$\sqrt{900}$

Ⓕ

$\sqrt{2,500}$

Ⓐ

$\sqrt{6,400}$

Ⓖ

$\sqrt{10,000}$

III. Simplify each absolute value.

Ⓔ

$|225|$

Ⓕ

$|121|$

Ⓐ

$|-625|$

Ⓔ The distance between -11 and 0.

Ⓐ

$|4| + |3|$

Ⓔ

$|14|$

Ⓐ

$|5| - |3|$

Ⓖ

$-|-3| + 8$

Ⓖ

$|10|$

Ⓔ

One half of the absolute value of 1.

Ⓖ

$|-1| - |0.1|$

Ⓐ

$|-4|$

Answers for Part I and Part II

Ⓐ

$|-15|$

7 9 11 12 20 60 30 5 80 4 2 3 50 10 100 6 90 8 1

Answers for Part III

18 10 121 11 12 0.1 14 25 0.5 15 0.4 0.9 225 7 5 715 4 625 2